

SPIKA NG 160

115 V / 60 Hz

SELF-CONTAINED ICE CUBE MACHINE

FEATURES

- ▶ PRODUCES FULL DICE ICE CUBES OR HALF DICE ICE CUBES.
- ▶ STIF: STRONG INOX FRAME. SOLID MACHINE STRUCTURE IN 4 COLUMNS WITH AISI 304 STAINLESS STEEL FRAME.
- ▶ STRONGEST DOOR IN THE MARKET. MADE OF STAINLESS STEEL. OPENING AND DAMPING SYSTEM PATENTED BY ITV.
- ▶ SMART FRONT VENTILATION SYSTEM, (SFVS) ALLOWS BUILT-IN INSTALLATION OF THE UNIT.
- ▶ CLEANING SWITCH: ALLOWS CIRCULATION OF WATER WITH DESCALING PRODUCT (CALKIN OR SIMILAR) WITHOUT COOLING.
- ▶ "NEVER STOP" MOTOR PUMP DEVELOPED BY ITV. PUMP WITHOUT SEALS, WHICH AVOIDS DETERIORATION IN HARD WATER.
- ▶ EASI: EASY ACCESS FOR SERVICE & INSTALLATION. ALL PANELS CAN BE DISASSEMBLED SEPARATELY.
- ▶ ELECTRONIC CONTROL THAT ENHANCES THE PERFORMANCE OF THE MACHINE AND ALLOWS IT TO ADAPT TO EXTREME CLIMATES.
- ▶ NATURAL GAS R290 WITH VERY LOW GLOBAL WARMING POTENTIAL WHICH ALSO REDUCES THE ENERGY CONSUMPTION.
- ▶ LED ON/OFF SWITCH / PCB MOUNTED AT THE BOTTOM.
- ▶ TROPICALIZED MACHINES (T CLASS) / STAINLESS STEEL ADJUSTABLE LEGS.



	24 H	70°F/20°C	50°F/10°C	90°F/32°C	70°F/21°C	lbs (Kg)	in (mm)	in (mm)	SPIKA HALF DICE 0.9" (W) x 0.43" (D) x 1.02" (H) 23 mm (W) x 11 mm (D) x 26 mm (H) Average dimensions
SPIKA NG 160 H		159 (72)	117 (53)	44.1 (20)	Width 21.07" (535)	Width 24.02" (610)	SPIKA FULL DICE 1.02" (W) x 0.9" (D) x 1.02" (H) 26 mm (W) x 23 mm (D) x 26 mm (H) Average dimensions		
SPIKA NG 160 F		159 (72)	117 (53)		Depth 23.43" (595)	Depth 25.79" (655)			
					Height* 31.07" (789)	Height 35.83" (910)			

* WITH LEGS 35"/37"

ACCESSORIES

INCLUDED



6" HEIGHT ADJUSTABLE LEG KIT



SCOOP

NOT INCLUDED



10" FILTER
ANTI-LIMESCALE + ANTI-CHLORINE
CS-101 K



10" REPLACEMENT CARTRIDGE
ANTI-LIMESCALE + ANTI-CHLORINE
CS10



SCALE KLEEN

TECHNICAL SCHEME

SPIKA NG 160

FRONTAL VIEW

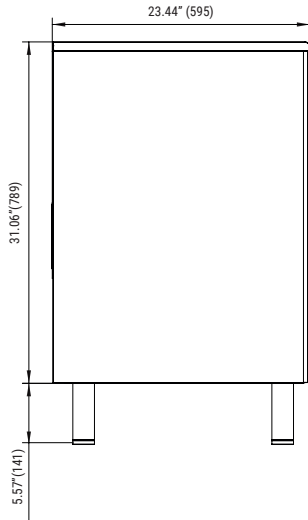

SIDE VIEW

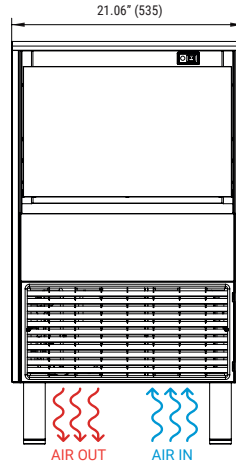

REAR VIEW

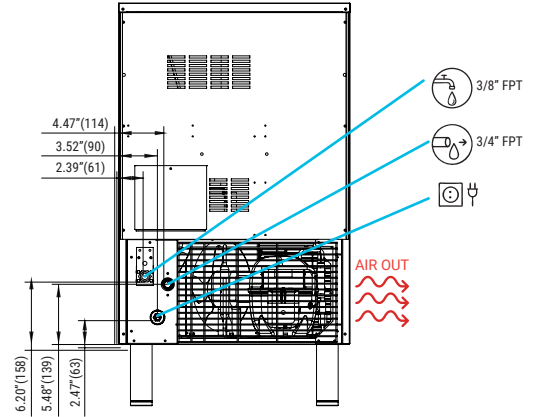

* All dimensions in inches (and mm)

OPERATING CONDITIONS

PRODUCTION (LBS) 60Hz

- ±10% V
- 41°F/109°F
- 41°F/95°F
- 14.5 psi (1 bar) /87 psi(6 bar)
- 75/150 Ice cubes/cycle



V	Hz	ph
115	60	1N

MODELS	Kwh/100 lbs	Water Usage (Gal/100 lbs)	Ice Production (70/50)	Ice Production (90/70)	External Dimensions (inches)			Voltage /Hz /ph	Amp	Heat Rejected (BTU/hr)	Net Weight (lbs)	Crated Weight (lbs)
					W	D	H					
SPIKA NG 160 H	4.89	20.86	159	117	21.07	23.43	31.07	115/60/1	5.2	2,274	106	123.5
SPIKA NG 160 F	4.89	20.86	159	117	21.07	23.43	31.07	115/60/1	5.2	2,274	106	123.5



ITV Ice Makers, Inc.
9550 Satellite Blvd, Suite 100
Orlando, FL 32837
Phone: 1 407 826 1860 | Fax: 1 407 826 1861
Toll Free: 1 888 488 1423
sales@itvice.com | www.itvice.com



SERVICE
service@itvice.com
Skype: service@itvice.com
PHONE: +1 888 488 1423
FROM 8AM TO 5PM EST



2 ADDITIONAL YEARS ON COMPRESSOR & EVAPORATOR
Read our warranty policy to know more about limitations and exclusions

