

VIELLE BRIDGE

COUNTER MOUNT TOWER

PROJECT NAME: _____ ITEM #: _____

APPROVED BY: _____ DATE: _____

TOWER NOMENCLATURE:

VIELLE - 10F - B - CM - BI

STYLE OF TOWER
 NUMBER OF FAUCETS
 MOUNT TYPE
 TOWER FINISH

INCLUDED HARDWARE: 1/2" - 13 x 5" BOLTS & NUTS
 TOWER MADE OF BLACK IRON

DISCLAIMERS:
 • CHILL RITE RESERVES THE RIGHT TO CHANGE MEASUREMENTS WITHOUT NOTICE.
 • THIS DRAWING IS THE SOLE PROPERTY OF CHILL RITE MANUFACTURING AND SHOULD NOT BE USED OR RECREATED WITHOUT WRITTEN CONSENT FROM CHILL RITE.
 • TAP HANDLES NOT INCLUDED.
 • COLORATION IS A DIGITAL REPRESENTATION AND DOES NOT REFLECT THE ACTUAL COLOR

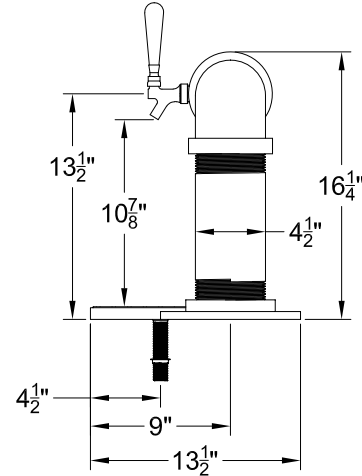
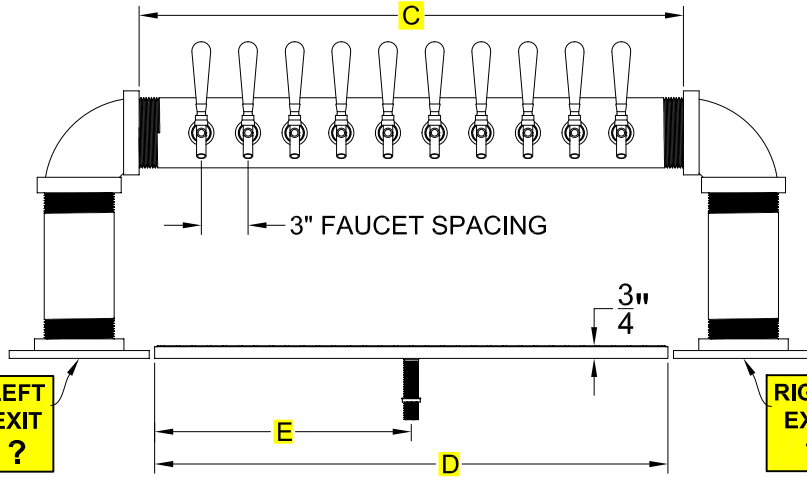
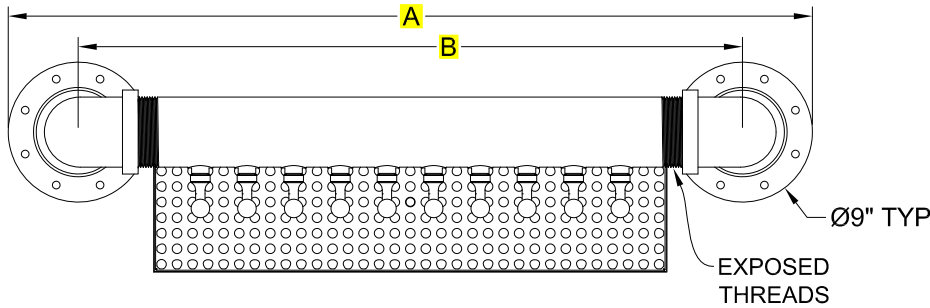

• TOWER WILL RUST AND TARNISH OVER TIME •

• PLEASE CHOOSE NUMBER OF FAUCETS BELOW •

FAUCETS	A	B	C	D	E
<input type="checkbox"/> 4	31.71	24.71	17	15	6.5
<input type="checkbox"/> 5	34.71	27.71	20	15	6.5
<input type="checkbox"/> 6	37.71	30.71	23	21	9.5
<input type="checkbox"/> 7	42.71	33.71	26	21	9.5
<input type="checkbox"/> 8	45.71	36.71	29	27	13.5
<input type="checkbox"/> 9	48.71	39.71	32	27	13.5
<input type="checkbox"/> 10	51.71	42.71	35	33	16.5
<input type="checkbox"/> 11	54.71	45.71	38	33	16.5
<input type="checkbox"/> 12	57.71	48.71	41	39	19.5
<input type="checkbox"/> 13	60.71	51.71	44	39	19.5
<input type="checkbox"/> 14	63.71	54.71	47	45	22.5
<input type="checkbox"/> 15	66.71	57.71	50	45	22.5
• TWO DRAINS REQUIRED ON ALL DRIP PANS OVER 45" WIDE •					
<input type="checkbox"/> 16	69.71	60.71	53	51	17
<input type="checkbox"/> 17	72.71	63.71	56	51	17
<input type="checkbox"/> 18	75.71	66.71	59	57	19
• LINES EXIT BOTH SIDES OF TOWER IF OVER 18 FAUCETS •					
<input type="checkbox"/> 19	78.71	69.71	62	57	19
<input type="checkbox"/> 20	81.71	72.71	65	63	21
<input type="checkbox"/> 21	84.71	75.71	68	63	21
<input type="checkbox"/> 22	87.71	78.71	71	69	23
<input type="checkbox"/> 23	90.71	81.71	74	69	23
<input type="checkbox"/> 24	93.71	84.71	77	75	25
<input type="checkbox"/> 25	96.71	87.71	80	75	25
<input type="checkbox"/> 26	99.71	90.71	83	81	27

• PLEASE CHOOSE WHICH SIDE THE LINES EXIT 4-18 FAUCETS •

☐ LEFT

☐ RIGHT

ALL MEASUREMENTS ARE IN INCHES AND WEIGHTS IN POUNDS UNLESS OTHERWISE NOTED

• IF GLASS RINSER IS REQUIRED PLEASE SEE BELOW •

☐ CENTER or ☐ OFFSET

